



Portlaser[®]
Industrial Laser

FIBER MARK PRO MAX-I



Fiber laser workstation for marking and Engraving metals and plastics

MAIN FEATURES:

- Ytterbium fiber laser from 20W to 70W of laser power .
- Work areas of 70x70mm to 400x400mm.
- Status LED's
- Air cooling.
- Automatic indexer (rotary table) 2, 3, 4, 6 position
- Table diameter 700mm standard (optional up to 1200mm)
- Electric Z-axis and autofocus .

APPLICATIONS



Automotive Industry Component



Keypad



Silver Cutting

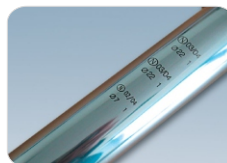

Metal (cylindrical parts)



Cutlery

www.portlaser.com



FIBER MARK PRO MAX-I

TECHNICAL FEATURES

MODEL:	FIBER MARK PRO MAX
Laser Power:	20W, 40W, 50W and 70W.
Laser Type:	Ytterbium-doped Fiber Laser.
Marking Area (mm):	70x70mm, 110x110mm, 200x200mm, 300x300mm
Maximum height of the part to be marked:	up to 600mm (with small focal lens)
Wavelength:	1064 nm
Maximum engraving speed:	>7000 mm/s.
MTBF:	+100.000 hours.
Preview:	Laser Diodes 650 nm 2mW
Workstation:	Automatic indexer (rotary table) 2, 3, 4, 6 position Table diameter 700mm standard (optional up to 1200mm)
Z axis:	Automatic (autofocus)
Standard Laser Safety:	CLASS 1 Laser System
Power Supply:	220-240V AC 50Hz.
Power Consumption:	750W-1KW.
Cooling System :	Air-cooled.
INTERFACE	
Control:	CAD software in Windows Environment .
File Format:	PLT, DXF, BMP, PCX, TIFF, JPEG, GIF MCL, etc.

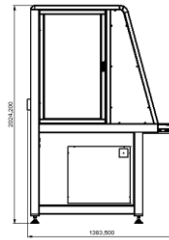
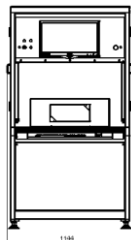

OPTIONS



Fume Extraction System
(With Filters)



Fume Extraction System
(Without Filters)

www.portlaser.com